

May 22, 2025 CAB Meeting

# Kautz Road Construction Entrance Alterations

**Ryan Johnson**

Civil Engineer, ISD/Engineering



U.S. DEPARTMENT  
of **ENERGY**

Fermi National Accelerator Laboratory is managed by  
FermiForward for the U.S. Department of Energy Office of Science



# Kautz Road Construction Entrance

## Overview

### What is Fermilab doing?

Improving the Kautz Road site entrance for use as an access for construction-related traffic to support large lab construction projects (LBNF, PIP-II, UIP).

### When will this occur?

Roadway construction is expected to begin Summer 2025 (July - September)

### What is the impact to the public?

IL-56 traffic control in place for improvements to IDOT right-of-way. Motoring public to drive with caution & obey temporary traffic control devices (striping, signage, barriers).

Permanent impacts: Increased construction traffic through access for construction at lab. No impact to IL-56 traffic.



# Kautz Road Construction Entrance

## Transportation Impact Study

- Traffic simulations were shown on this slide.
- The following scenarios were modeled:
  - Right & left turn lanes to Butterfield and Kautz. (This would back up and delay traffic on Butterfield)
  - Butterfield merging lane out of Kautz. (No benefit)
  - Traffic light to allow full traffic movements. (Adds unnecessary delays to Butterfield, expensive).
  - Kautz Rd Right-in/Right-out
- Restricting the Kautz Rd traffic to right-in/right-out was the most effective:
  - Least impact to the Butterfield Rd traffic. It would stay free-flowing and would remain a Level of Service A
  - Cost effective
- Adding a right-in turn lane to westbound Butterfield into Kautz has no benefit to the Butterfield traffic flow, but will increase public safety by reducing the potential of rear-end collisions with vehicles entering our site.
- We opted to move forward with the right-in/right-out configuration with the right-in turn lane. IDOT accepted.



# Kautz Road Construction Entrance

## Existing Conditions

- Original farm road, non-operational since the 90's
- Deteriorated Pavement: 20' wide, 2' thick



Existing Kautz Road Entrance – From IL-56 Looking North



Existing Kautz Road Entrance – From Kautz Looking South



Existing Kautz Road – Looking South



# Kautz Road Construction Entrance

## Improvements

- IDOT (Public) Right-of-Way:

- Right-in turn lane on IL-56
- Widened intersection, pavement reconstruction and new curbs
- Curbed island to enforce right-in/right-out traffic movements
- Traffic Control
- IDOT Highway Permit

- Fermilab Site:

- Widen roadway to 28', reconstruct from IL-56 to Indian Creek Rd.
- Security access point:
  - Guardhouse, Queueing Area, Turn-Around Lane, Lighting
- Resurface Indian Creek Rd. from Kautz to LBNF site

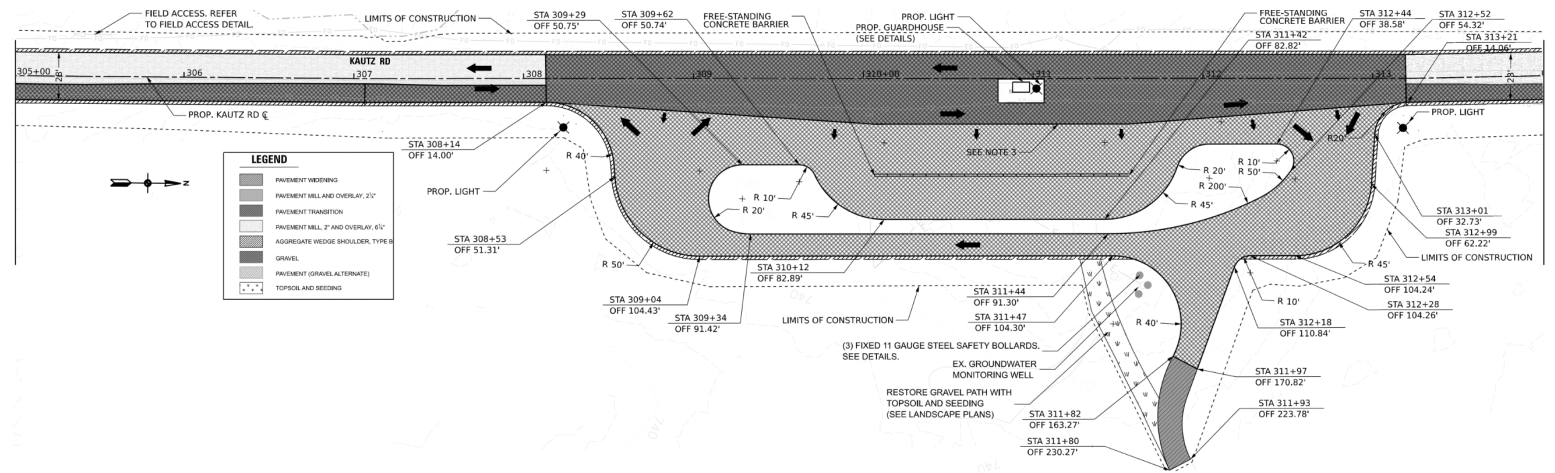

Access Control Improvements to Fermilab Site

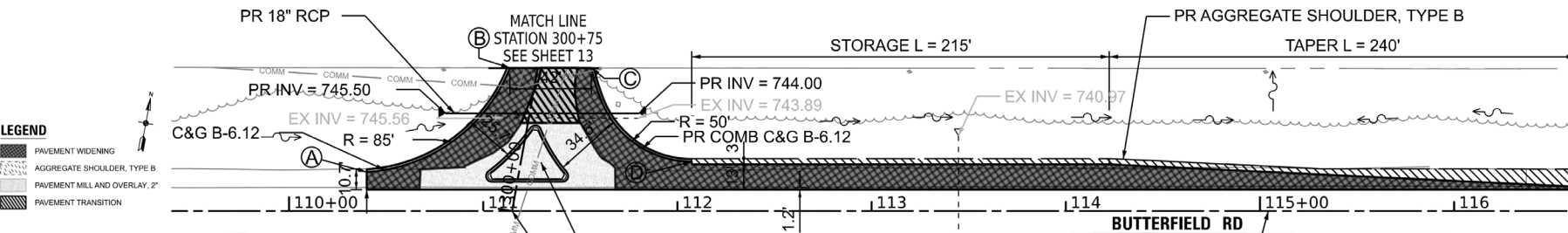

Improvements to IL-56 at Kautz Rd.



## Kautz Road Construction Entrance

Project Improvements





Fermi**FORWARD**



U.S. DEPARTMENT  
*of* ENERGY